

MPT-300

REMOTE CONTROL KEYFOB

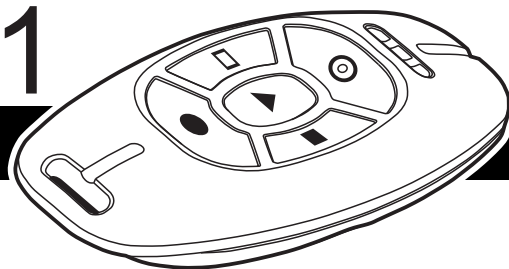

mpt300_en 03/12

The MPT-300 keyfob enables you to operate the MICRA security system (firmware version 2.02 or newer). Information on adding keyfobs and functions that can be run with their assistance is contained in the MICRA alarm module manual.

1. Features

- Transmissions secured by KeeLoq code hopping.
- 5 buttons to run up to 6 selected functions.
- Key press LED indicator.

2. Specifications

Operating frequency band	433,05 ÷ 434,79 MHz
Radio communication range (in open area)	up to 100 m
Battery	2 x CR2016 3V
Environmental class according to EN50130-5	II
Operating temperature range.....	-10 °C...+55 °C
Maximum humidity	93±3%
Enclosure dimensions.....	38 x 78 x 16 mm
Weight.....	30 g

Hereby, SATEL sp. z o.o., declares that this keyfob is in compliance with the essential requirements and other relevant provisions of Directive 1999/5/EC. The declaration of conformity may be consulted at www.satel.eu/ce

3. Battery replacement

The battery life depends exclusively on how the keyfob is used. The more frequently the buttons are pressed, the higher the power consumption is. Each transmission sent from the keyfob contains information on the battery status. If the battery is low, the MICRA module can notify about it through an SMS message or by using the CLIP service. Such an event can also be monitored. The way of battery replacement is illustrated in Figures 1-9. Discharged batteries must be disposed of in accordance with applicable environmental regulations.



There is a danger of battery explosion when using a different battery than recommended by the manufacturer, or handling the battery improperly.

Be particularly careful during installation and replacement of the battery. The manufacturer is not liable for the consequences of incorrect installation of the battery.

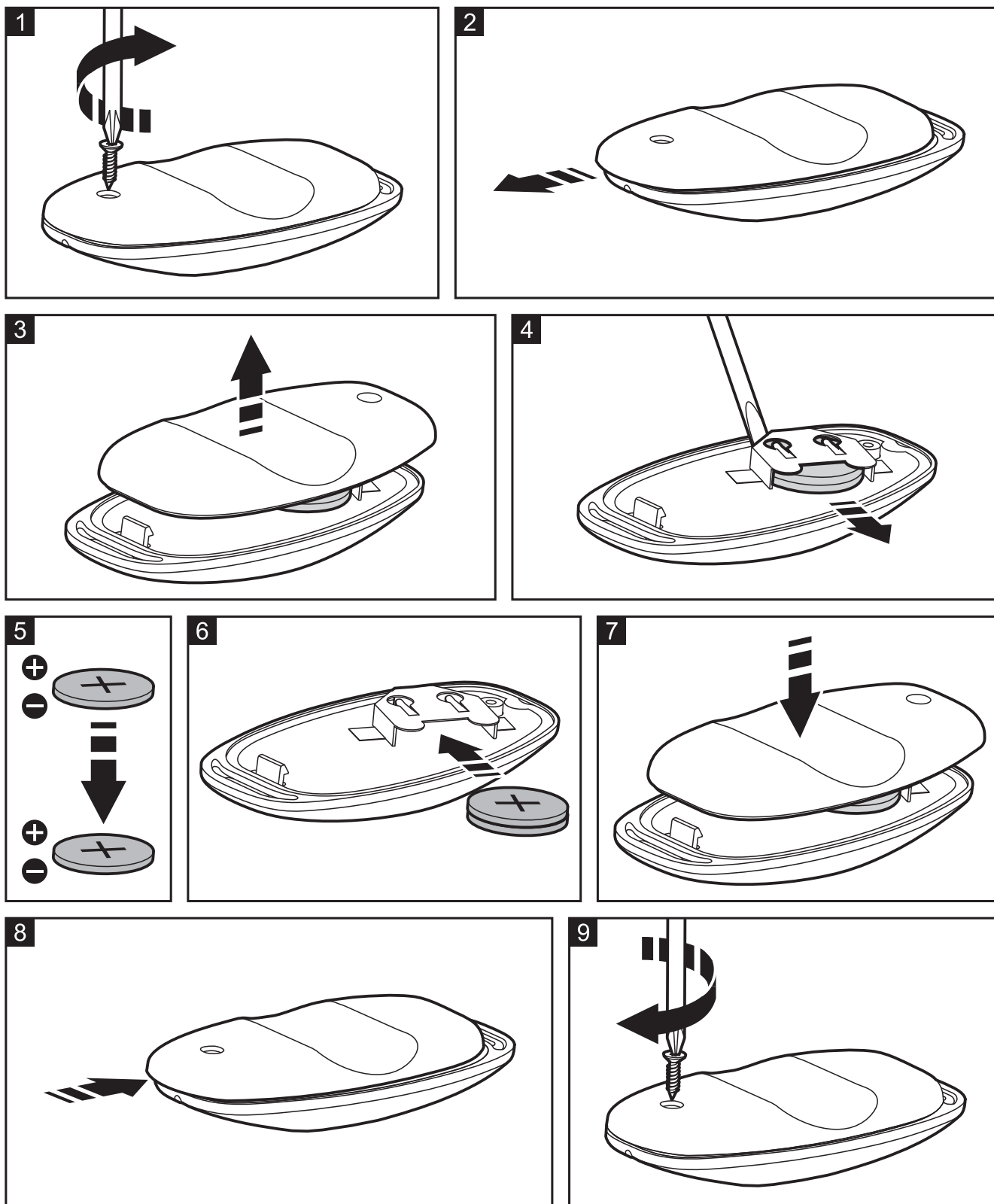

SATEL sp. z o.o.
ul. Schuberta 79
80-172 Gdańsk
POLAND
tel. + 48 58 320 94 00
info@satel.pl
www.satel.pl